

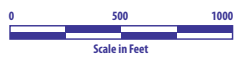

KINO SPORTS COMPLEX AREA MAP

SUN BELT COLLEGE LEAGUE

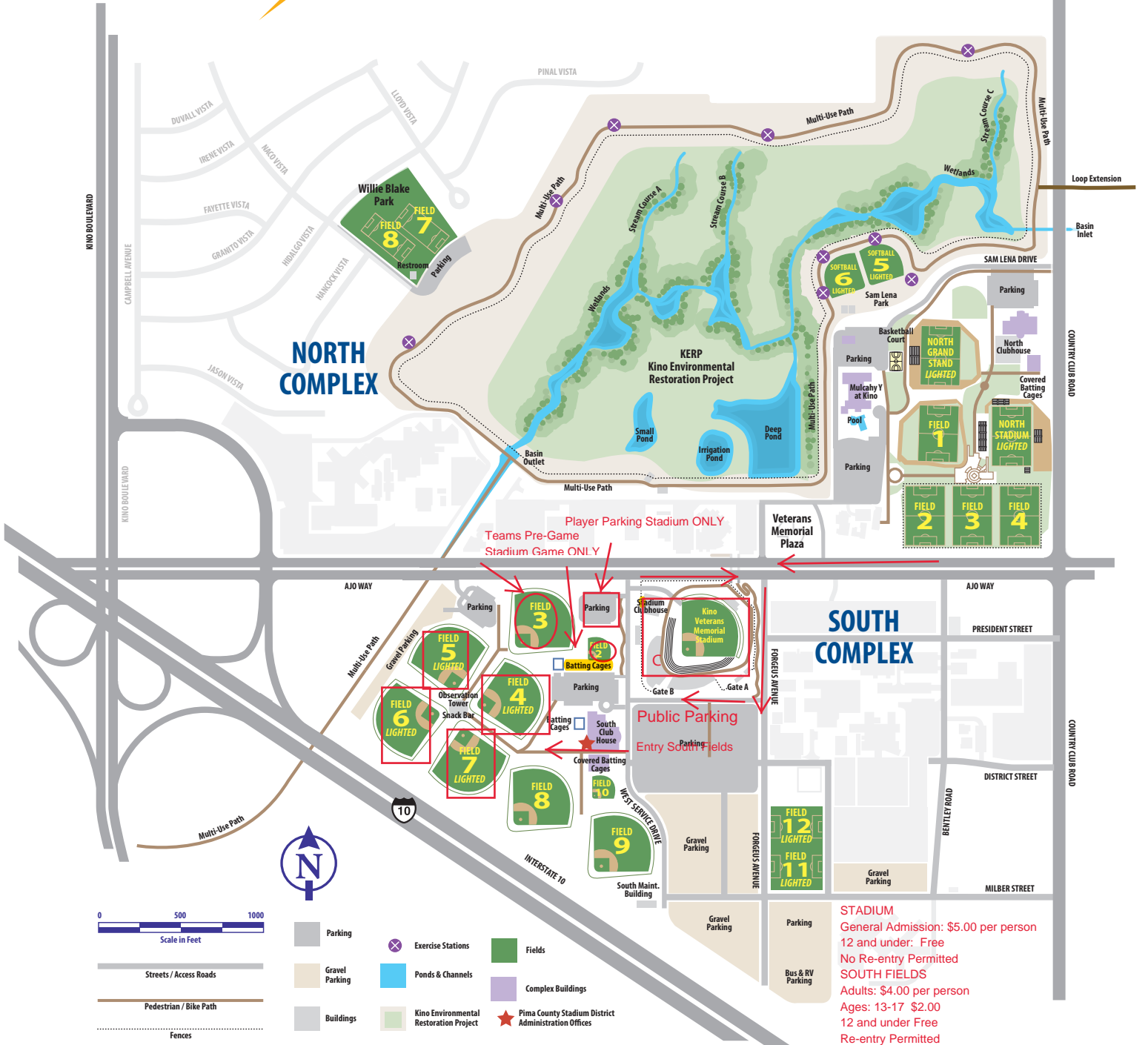

- Parking
- Gravel Parking
- Buildings
- Exercise Stations
- Ponds & Channels
- Fields
- Complex Buildings
- Kino Environmental Restoration Project
- Pima County Stadium District Administration Offices

STADIUM
 General Admission: \$5.00 per person
 12 and under: Free
 No Re-entry Permitted

SOUTH FIELDS
 Adults: \$4.00 per person
 Ages: 13-17 \$2.00
 12 and under Free
 Re-entry Permitted

STADIUM
 Gates open to public 1 hour prior to game time
 Public Access Gate B
 Security Bag Checks
 Clear Bag Policy
 No outside food or beverage permitted
 Bottled water permitted
 No coolers or any kind or size permitted
 No chairs, pop up tents, umbrellas permitted
 For further policies www.sunbeltcbl.siplay.com
 Full concessions with beer sales offered
 Must be 21 with ID to be served beer
GENERAL ADMISSION: \$5.00 per person
12 AND UNDER: FREE
 No re-entry permitted

SOUTH FIELDS 4-5-6-7
 Gates open to public 1 hour prior to game time
 No outside beverages (coffee, soda, ice, etc.), food permitted
 No outside coolers of any size or kind permitted (THIS INCLUDES TEAM COOLERS)
 Bottled water, power ade permitted
 Players permitted to bring in as much water as possible
 Water jugs with cups provided to each dugout for the players and coaches
 Random bag checks may be conducted by event/security staff
 Pop up tents, lawn chairs permitted
 For further policies www.sunbeltcbl.siplay.com
 Full concessions offered (No beer sales)
ADMISSION: \$4.00 per adult; Ages: 13-17 \$2.00; 12 and under FREE
 Re-entry permitted with purchased ticket